

THE INFORMATION DISCLOSED HEREIN WAS ORIGINATED BY AND IS THE PROPERTY OF MAGTROL SA. MAGTROL SA RESERVES ALL PATENT PROPRIETARY, DESIGN, USE, SALE, MANUFACTURING AND REPRODUCTION RIGHTS THERETO.

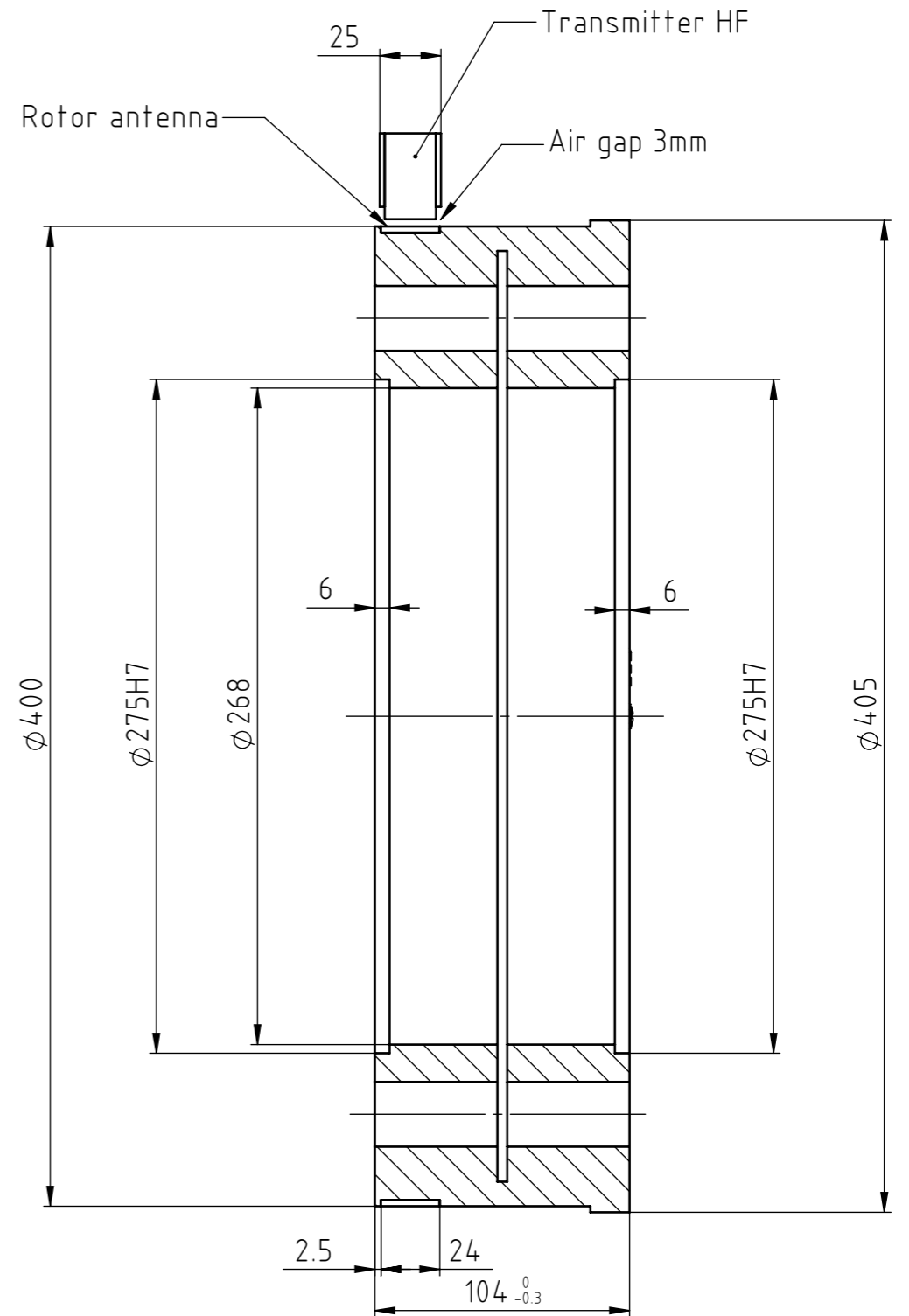

Error of linearity: 0.25%
 Maximum torque: 150% of nominal
 Maximum speed: 1'500 rpm
 Sensitivity: 1mV/V
 Strain gauge bridge: 700Ω
 Rated temperature range: +10°C to + 85°C
 Storage temperature range: -25°C to + 85°C
 Protection class: IP42

6									
5									
4									
3									
2									
1	14.04.08	08033	blot	blot	Changement de capteur de vitesse				
Rev.	Date	PM	Drawn	Appr.	Repl. by :				
					Repl. for:				
Tolerances: ±					mm to 50mm, ± mm over 50mm				
Material:					Scale 1:2.7				
Finish:					DRAWING N°				
TF220 (100kNm)					425-220-000V011				
Torque Flange TF200									

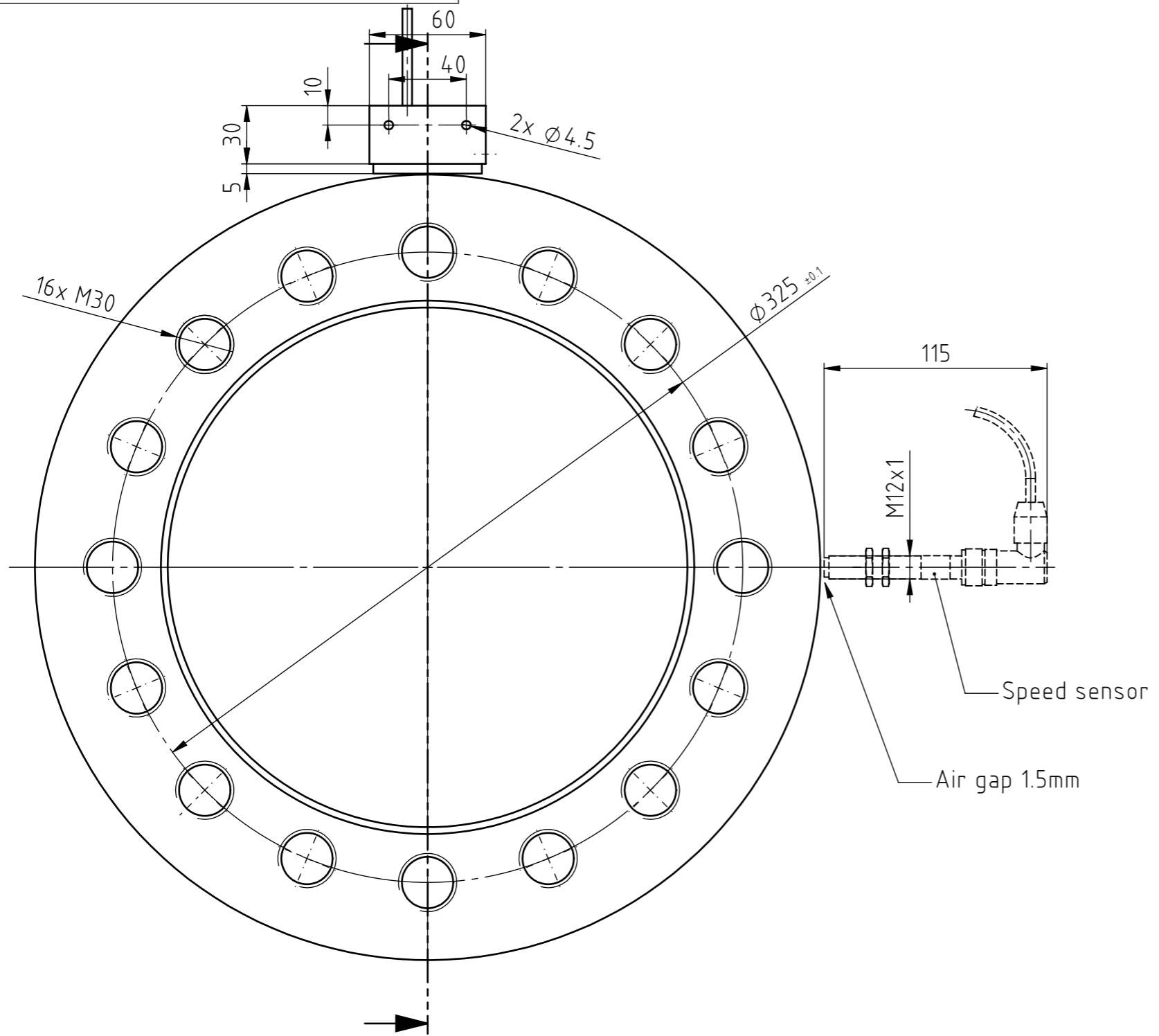

Drawn	06.09.05	B.Lottenbach
Checked		
Approved	06.09.05	B.Lottenbach